

# NORTHLAND PREPARATORY ACADEMY

3300 E Sparrow Avenue, Flagstaff, AZ 86004  
928.214.8776 928.214.8778 (f)  
tpost@northlandprep.org www.northlandprep.org



## MARCH 2010

Teachers' weekly homework assignments: <http://www.homeworknow.com/fetch/?number=40009701178>  
NPA calendar of events: <http://www.google.com/calendar/embed?src=tpost@northlandprep.org>

### Message from Mr. Lombardi, Superintendent

#### ALL REGION MUSIC FESTIVAL

It was my pleasure to accompany students participating in the All Region Music Festival held in Phoenix February 18th through the 20th. Twenty-eight NPA Band, Choir and Strings students were accepted after auditions were held to participate in Band, Choir and Orchestra. Students work with specially selected clinicians who are able to quickly develop the many students from around the state into cohesive performing ensembles. The level of talent is extremely high and the progress exhibited in the three days is amazing.

Several things quickly become apparent. One is that our small school has an inordinately large number of students participating relative to the size of our school. Another is the family type of atmosphere displayed by our group. We were afforded positive comments from the hotel management and restaurants. Teachers from other schools asked questions regarding our establishment, programming, administration, parental support and students. NPA students and NPA adults worked hand in hand to accomplish our goals of positive use of time, energy and resources to make what could be three long days turn into three days of harmony (pun intended).

Congratulations to the students who participated in the All Region Music Festival.

#### GENEROSITY

NPA has been in desperate need of additional ways of transporting our students for sporting events, music events and class field trips. We have definitely grown past the abilities of our two 2004 Chevy Astro Vans, each capable of transporting 7 students. This need is obvious to parents who have accompanied or chaperoned. Budget Rent-A-Car (van) has definitely enjoyed our business this past year!

*(Continued on page 2)*

### INSIDE THIS ISSUE

Mrs. Post	2	Parent-Teacher Conference Week	4	NPA Graduation—Save the Date!	5
Lost and Found	2	Bake Sale	4	News from the Music Department	6
Mr. Danner	3	Homework Now!	4	Tissues/Wipes Needed	6
Volunteer Needed: Newsletter Editor	3	Student Recognition	5	Thank you	6
Early Release	4	Finishing School at Brix Restaurant	5	Community Enrichment Committee	7
		Yearbook	5	NPA Driveway Safety	8
				2009-10 Above and Beyond	9

## Mrs. Post, Principal

March is the kick-off of NPA's extremely busy spring. During the month of March we have:

- Baseball, Softball and Track beginning
- Parent/Teacher Conferences (3-2/3-4)
- Odyssey of the Mind Regional Tournament (3-6 at NAU)
- NPA Spirit Week (3-8/3-12)
- Spring Break (3-15/3-19)
- China Trip during Spring Break
- 8th Grade Magic Mountain Physics Trip
- 7th Grade orientation (3-31)

Check out the [NPA Google Calendar](#) for more complete listings of NPA happenings.

June 4th will be the last day of school which is day number 180 (state minimum for instructional days).

Each and every year, the Arizona State Board for Charter Schools requires each charter school entity to give a brief survey to its parents asking one question, "How would you rate the quality of education at NPA?" The responses available were, Excellent, Good, Fair and Poor. 116 (42%) NPA families responded to the survey and 98 responded that they felt the quality of education at NPA was Excellent and 8 responded that they felt that the quality of education at NPA was Good. No respondents reported anything lower than Good. I think that is a terrifically positive response. Thank you all who took the time to respond.

A huge thank you to the CEC (Community Enrichment Committee) for taking care of the teachers/staff of NPA during the Parent/ Teacher conferences as they are providing lunches for us on each of the 3 conference days.

## Lost and Found

There are a lot of jackets, sweatshirts, backpacks, and etc. still in Jail in my office. These items will be on display for you during Parent-Teacher Conferences (March 2, 3, 4). At that time, items can be claimed for \$1.00. You are also welcome to come to my office to check for your student's belonging. During Spring Break, all items left in Jail will be donated to the Women and Children Shelter in town. Friday, March 12th will be the last day for items to be claimed. Thank you, Ms. Sell

## Mr. Lombardi, continued

*(Continued from page 1)*

On Thursday, 2/18, The Milligan family generously moved to partially address this need through the donation of a gently used 12 passenger van. The timing turned out to be excellent as on the evening of 2/20 one of our two Astro Vans was incapacitated with mechanical failure. I do not anticipate it returning to service quickly. The new 12 passenger Dodge allows us to continue offering our students opportunities away from our campus.

With funding becoming tighter due to diminished state budgets, generosity from our parent community is something we will continue to embrace with open arms. Thank you to those who see a need and are able to contribute through your time, talents and contributions!

## Mr. Danner, Assistant Principal and Guidance Counselor

Hello, everyone. Happy March!

### EDUCATION AND CAREER ACTION PLANNING UNDERWAY

I am beginning work with students to use the tools provided by the state for them to develop their Education and Career Action Plans, which are required for students beginning with the Class of 2013. In March, I am meeting with freshmen and 8th graders to get them started with the various components of the ECAP, which is a web-based set of education and career planning tools with a portfolio, resume creator, and portal with dozens of useful links to post-secondary options, programs, and career data. I have set up an account for all 8th & 9th grade students. The first piece we are working on is getting their four-year high school tentative course plans entered into their accounts. The website is below for parents to check out. There is a wealth of information there:

<http://www.azcis.intocareers.org>

### SNOW SHOVELING FOLLOWUP

We need to send out apologies to NPA Parent Mark Wagner, whose name was inadvertently left off the list of thanks for shoveling the NPA roof in January. While on the subject of snow, I will add thanks to Hoyt and Barb Pinaire for a donation of 500 pounds of ice melt. It has definitely come in handy.

### SCHEDULING FOR 2010-2011

Teachers will be discussing course options and placements for 2010-11 with students after Spring Break, and students will put together drafts of their course selection sheets at that time. Parents are encouraged to consult with teachers during conference appointments if they have any questions about course placements for next year. The actual course selection cards will be completed during the week of March 29th. As always, I appreciate everyone's understanding with the uncertainties that exist every year over which exact courses will be offered. It's very chicken-and-egg, with offerings depending on selections, selections depending on offerings, and staffing constraints always lingering in the background that will have an as yet unknown impact on the final master schedule. Not everything listed as a choice on the course selection card will necessarily be in the schedule, and that is why students are instructed to put multiple choices for their course selections.

If your child will not be returning to NPA next year, please indicate as such on the course selection form. Thank you for your help in getting those forms signed and returned right away. It's very helpful.

### HEALTH REQUIREMENT REMINDER

Also related to scheduling, those who still need to satisfy NPA's High School Health requirement should take a

*(Continued on page 4)*

## Volunteer Needed—Newsletter Editor

**Are you looking for a way to help out NPA, but not sure what's needed?**

How about editing the NPA monthly newsletter? I can train, provide templates, or do what ever you need to make the transition a smooth one. If you are interested or have questions, please contact me! ~ Lynn, [burchl@npgcable.com](mailto:burchl@npgcable.com)



## Mr. Danner, continued

*(Continued from page 3)*

look at <http://www.northlandprep.org/docs/Satisfying%20NPA%20Health%20Requirement.htm> and chart a plan for how they will satisfy it.

### PLAN TEST FOR SOPHOMORES APRIL 13TH – FEE DUE MARCH 31ST

The ACT program offers a test called **PLAN**. It is designed for 10th grade students, and is essentially a Pre-ACT the same way that the PSAT is a preliminary version of the SAT. More info is available at <http://www.act.org/plan/>. Registration happens through me at NPA, but more info is at the website. NPA will administer this test to all sophomores on the morning of Tuesday, April 13th, when the 10th

graders will have finished their AIMS tests but the 7th – 9th graders will still be working on the rest of the state exams. **There is a \$10 fee for this exam, payable to NPA by March 31st.** Fee waivers are available for those who qualify for free/reduced lunch or are unable for other reasons to pay the fee. While I cannot require that every sophomore take this exam, I **highly, highly** recommend it. What this year's juniors have found is that a majority of them performed better on the PLAN than they did on the PSAT, thereby discovering that the ACT may be a better college entrance exam for their purposes. **The big point is to try both exam formats to see which one lines up better with each student's learning and test-taking strengths.** Parents, thank you for your help in getting students to sit for this test.

## Early Release

We will have early release on Tuesday 3/2, Wednesday 3/3, Thursday 3/4, and Friday 3/5. All four days with a release time of 1 pm.

## Parent-Teacher Conference Week

A quick reminder for those of you that are signed up for Parent-Teacher Conferences, they are next week as follows:

Tuesday 3/2—Conferences will be held from 3:00 p.m. to 6:00 p.m.

Wednesday 3/3—Conferences will be held from 2:00 p.m. to 5:00 p.m.

Thursday 3/4—Conferences will be held from 2:00 p.m. to 5:00 p.m.

Friday 3/5—Students will be released early at 1:00 p.m.

## Bake Sale

NJHS and NHS will be sponsoring a bake sale as part of their fund raising drive for the Leukemia and Lymphoma Society. This bake sale will run during Parent-Teacher Conferences on March 2nd, 3rd, and 4th. Take home dessert and support a very worthy cause.

## Homework Now!

Visit [www.homeworknow.com](http://www.homeworknow.com) to register yourself to receive updates when your child's teachers update their HomeworkNow pages. The information can be routed to your email address or mobile phone!

### Student Recognition

Seva Haug Baltzell participated in the annual state-wide NATS (National Association of Teachers of Singing) singing competition this past weekend and placed 2nd in her division of OYW, young high school women. She sang a French piece, Nuit d'etoiles by Claude Debussy and a song in Italian entitled Che fiero costume by Giovanni Legrenzi. Her teacher is Deborah Raymond who teaches classical vocal and opera at NAU. For more information, please see [www.vsnats.org](http://www.vsnats.org).

Congratulations Seva!

### Finishing School at Brix Restaurant *by: Chris Sogge*

<p>This year's senior class had the chance to participate in a fun etiquette training held at Brix restaurant. It was sponsored by parents (and other friends of NPA) through tax credit and</p>	<p>donation, so the seniors got to eat the delicious four-course meal for free. The Brix staff was blown away by how well everyone acted. Even Krishen Blows dressed up for the event, and</p>	<p>Matt Mellott said, "it was great." It was a great atmosphere and everyone enjoyed it. Thanks again to all the people who donated.</p>
--	--	--

### Yearbook

Sports and Dance Photos are available for purchase to support the NPA Yearbook.

To view proofs, and order online, go to: <http://www.photoshelter.com/c/bethlacour>

Password for all NPA categories is 2010nprepa

You may place your order for team or formal photos online or bring check and photo number to the NPA reception desk.

There is still limited Ad space in the NPA 2010 Yearbook. Help support the publication of our book by placing an ad.

All Pages are approximately 7 1/2" by 10 1/2"

1/8 of a page - \$ 50.00

1/4 of a page - \$80.00

1/2 of a page - \$140.00

A full page - \$215.00

To place an ad, contact Beth LaCour, Yearbook Adviser

### NPA Graduation—Save the date!

#### NPA's Graduation Ceremony

Saturday, May 22<sup>nd</sup> at 2:00pm at NAU's Ardrey Auditorium



The class of 2010 graduates in less than three months. Details are being worked out for a luncheon before the ceremony. Watch for upcoming information. If you are interested in helping, contact Margaret Rynn; [mrynn@infomagic.net](mailto:mrynn@infomagic.net)

## News from the Music Department

### Congratulations to:

- NPA Jazz Choir!! They received a SUPERIOR rating at the NAU Jazz/Madrigal Festival February 13.
- The 26 NPA students who attended the NW High School Regional Music Festival in Phoenix, February 18-20. It was an amazing event filled with incredible music performed by the top musicians in Northern Arizona. A special thanks to Mr. Sample, Ms Reid, Mrs. Bain and Mr. Lombardi for driving kids, feeding kids, supervising kids, running errands for kids, listening to kids and whatever else the kids needed during the festival!
- The 8 NPA students who have been chosen to participate in the NW Middle School Regional Festival in Lake Havasu, April 30-May 1.
- NPA Symphonic Strings!! They received an EXCELLENT rating at the Arizona Band and Orchestra Directors' Area Concert Festival February 25.



Just a reminder of up-coming dates:

- March 8, 6pm Choir/Guitar Concert @ Mountain View Baptist Church
- March 12, Final payment for the CA trip due
- March 13, All-State auditions @ Gilbert High School
- April 15-17, All-State Festival @ NAU
- April 21, 6:30pm: Concert to preview the CA Competition music
- April 22-25 Forum Festival Competition in Anaheim, CA

We have the best kids!

## Tissues/Wipes Needed

Parents—You all have been so great in the past with helping us keep up on our stock of tissues and Clorox wipes. With all the illnesses we have had, we are in great need of more tissues and wipes. Any donations would be greatly appreciated!



## Thank You Beverly Wagner!



Beverly introduced NPA to the new Fry's Gift Card Fundraising Program.

In the first six months, NPA accrued \$24,405.28 in reloads!

We were so close to the \$25K tier and receiving a 5% rebate.

NPA will be receiving a check in the amount of \$976.21 (a 4% rebate) from Fry's!

If anyone is interested in obtaining a gift card or has questions about the program, please contact Kathy Peretti at 928-522-0090

## Community Enrichment Committee

### Painless Fundraising Update—March 2010

Thank you for your participation in the various grocery store programs this year. NPA receives money back from your grocery, gas and pharmacy purchases!

Please be sure to link your grocery card to NPA for huge returns! If you shop at Alberson's, please pick up a card at the front desk for your key ring which can be swiped at the check-out.

#### Every dollar counts!

- Albertson's will give NPA \$79.74 for the period from November 1, 2009 - January 31, 2010
- Basha's has 38 participants in their "Shop & Give" program
- Fry's Cool Cash Program
  - ***For every \$50K in purchases we make, Fry's will pay NPA \$500***
    - Currently, NPA has **50 VIP participants**
    - VIP registered purchases total through February 12, 2010 is **\$63,527.62**
    - **NPA will receive \$500 from Fry's for reaching the first \$50K!**
    - Let's try for an additional \$500 if we reach \$100K in purchases!
    - This program ends on **April 24, 2010**
- Fry's Reloadable Gift Cards
  - This program runs year round
  - NPA can receive up to 6% of the total amount of reloads
  - From August 3, 2009 – January 31, 2010 ~ the accumulated reload total was **\$24,405**
  - **NPA will receive a 4% rebate from Fry's in the amount of \$976.21**
  - Current number of **active** participants: **18**
  - The next six-month period ends on July 31, 2010
- Safeway (escrip)
  - NPA will receive checks of \$198.82, \$230.53 and \$197.48 from escrip for the months of October, November and December

**THANK YOU! THANK YOU! THANK YOU! THANK YOU! THANK YOU!**

### PAINLESS FUNDRAISING CHECK-LIST

- **Albertson's Community Partner Program.** Obtain a Community Partner key ring card from the front desk (**NPA ID #49000126051**).
- **Bashas' Shop & Give.** Our NPA group **ID Number is 26061**. Ask a cashier to link your Thank You card to this number beginning **September 1, 2009**.
- **eScrip (Safeway).** Renewal ended October 31, 2009
- **Fry's Grocery Store "Cool Cash".** Take this bar code to the store with you and ask at the check out counter to have it linked to your Fry's VIP card. **Cards may be linked NOW!**



## NPA DRIVEWAY SAFETY

### Parents and Students:

We are once again asking for your cooperation in keeping safety as the main concern in our driveway, especially on days when road conditions are dangerous. Please read and adhere to the following and see the map on the reverse for detail. For snow delay days, add two hours to all morning times. Thank you in advance for your cooperation.

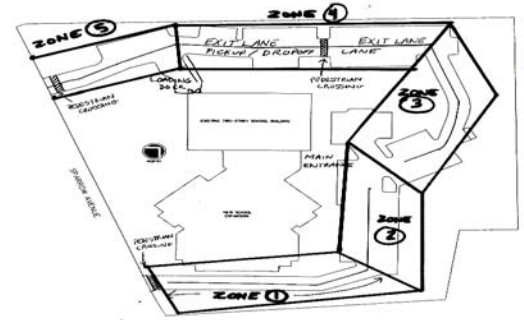

### On Regular, Clear Days

**Until 7:50 or 7:55 in the morning and until 3:20 in the afternoon, please drop off and pick up in the left lane of the top area (Zone 4).** The general thing to remember is to pull forward. What we often notice is that people who are impatient for the left lane to move ahead will drop off or pick up in Zone 2, and then traffic backs up because while those cars are stopped, traffic has cleared ahead, and the chance to pull forward is missed. We really want to avoid traffic backing up out onto Sparrow at the driveway entrance. Our neighbors and the City of Flagstaff want that too.

We are also noticing that the students try to make the top of the stairway the front of the line for dropoff and pickup. That shortens the length of the load/unload zone and ends up delaying the whole process. We ask parents to consider the ramp by the loading dock to be the front of the line and target that as the place to pull forward to. Of course, if you are in Zone 4 and all of the cars ahead of you are stopped, then go ahead and load/unload. We have added some pedestrian crossings; please do not stop where you would block them.

**At about 7:55 in the morning, if there is no more traffic behind you,** students may unload in Zone 2 in front of the main entrance.

**After 3:20 in the afternoon,** students are instructed to come down to the main entrance and should be picked up in Zone 2.

**The back loading dock door will be open starting at 7:45am all year.** We encourage students to use the loading dock door. 7th and 8th grade students especially should enter there as lockers are just inside that door.

**Students should NEVER be loading or unloading in Zone 3,** regardless of the weather conditions. It's too curvy and hilly. There is no sidewalk for students to access here. Right-lane drivers are not expecting any loading or unloading there. Again, for safety reasons, there should be no loading or unloading in Zone 3.

### On Snowy/Icy Days

**Plan extra time if possible.** If you don't relish the thought of waiting in the car line at 7:50, please try to get here earlier. On cold days, students can enter the lobby area as early as 7:15.

**The driveway MUST be a single lane in Zones 1, 2, and 3 on these days.** It is tight enough on clear days; on icy days it's just not safe to use the exit lane there. DO NOT ATTEMPT TO EXIT ON THE RIGHT UNTIL YOU REACH ZONE 4 AT THE TOP OF THE HILL.

**If the hill is especially icy,** a staff member will stop traffic at the bottom and allow one vehicle at a time to be on the hill. If this happens, please wait patiently until the vehicle ahead of you has turned the corner at the top before you proceed up the hill.

**Please drop off / pick up on the top driveway (Zone 4) ONLY.** Please wait until you get to the top area to load/unload. Even if you are in "gridlock" before that, the traffic will clear. Taking the extra time to load/unload near the main entrance makes it more likely that traffic back up out the driveway onto Sparrow. Plus, as the hill is single-lane on these days, there is NO advantage since vehicles cannot get into the exit lane until Zone 4 anyway.

**Don't let fear of tardiness lead to a dangerous situation, or more traffic delays.** We pride ourselves on sensibility. If students end up coming in slightly after 8:00am because people in the car line followed our instructions, or your own commute was delayed in the name of safety, please rest assured we will allow a grace period and not penalize students. Rather than parking to come in and excuse your child's tardiness, please just drop your child as described above. If we need to question the tardiness because it's past the grace period we set, our attendance staff will contact you.

THANK YOU FOR LIVING UP TO YOUR RESPONSIBILITY IN KEEPING YOUR CHILDREN AND ALL OTHER NPA CHILDREN SAFE.

## 2009-10 ABOVE AND BEYOND

### Fundraising Campaign

The NPA Fundraising Committee (a subcommittee of the NPA Board) continues to spearhead a fundraising campaign in which families, friends and community members can contribute directly to NPA's general operating fund to help ensure the financial well-being of NPA. The Committee asks that you consider giving \$200 for each of your children attending NPA. Below you will find the current tiered group members of the "Above & Beyond" Fundraising Campaign who have already contributed during the 2009-10 academic school year.

**TOTAL RECEIVED AS OF 2/25/2010: \$21,700**

**GOAL: \$72,000**

#### **GOLD TIER**

(\$1000 donation or more)

Mr. & Mrs. Brent Burch  
Mr. & Mrs. John Kalinich  
Mr. J. Kurt Mueller  
Roubos Family Foundation  
Trujillo Family

\*\*\*

#### **SILVER TIER**

(\$500 - \$999)

Mr. & Mrs. Joseph Huppenthal  
Dr. & Mrs. Paul Lundstrom  
Mr. & Mrs. Michael Martin  
Mr. & Mrs. Terrence Milligan  
Dr. Craig Steele &  
Dr. Heidi Wayment

\*\*\*

#### **BRONZE TIER**

(\$200 - \$499)

Mr. & Mrs. Joseph Ganey  
Mr. & Mrs. Donald Harkness  
Mr. & Mrs. Steve Jacobs  
Mr. Pramoud Keshav  
Mr. Tom Kolb & Mrs. Hattie Braun  
Mr. & Mrs. Gregg Landauer  
Mr. & Mrs. Tom McDaniel  
Dr. Ramona Mellott  
Mr. & Mrs. Craig Moody  
Mr. & Mrs. Steve Nicklason  
Mr. & Mrs. Bill Porter  
Mr. & Mrs. Doug Savery  
Mr. James Sobek  
Mr. Suchada Tirakul  
Mr. & Mrs. Mark Wagner

We also have families and friends who are not listed in the tiered list above but whose generous gifts are very much appreciated. Any amount you can give above and beyond your tax credit donation is needed. No amount is too small.

Please refer to the Above & Beyond donation form found on the NPA web site, [www.northlandprep.org](http://www.northlandprep.org), for more information about the fundraising campaign. In addition, our web site also has a link located in the upper left hand corner of our home page that reads "NPA TAX CREDIT DONATIONS." You may use this secure link for Above & Beyond contributions. Simply type "Above & Beyond" in the box when asked "What program or class are you donating to?"

***Thank you for your support of NPA!***